

# 2000 Series

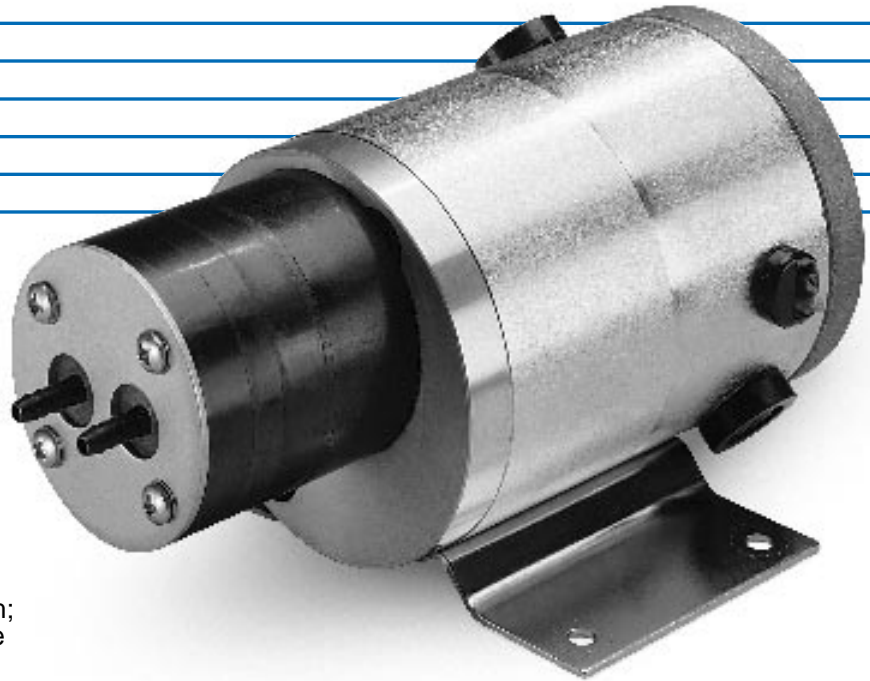

## Pump Specifications:

**Flow Rates** — Range to 1.01 gpm;  
maximum pressure  
240 psi

**Motor** — 12VDC, nominal,  
reversible, brush

**Fluid Temperature** — To 180°F (82°C)

## Materials in Contact with Solution:

**Body** — PPS Polymer (Ryton®)

**Seal** — a. Carbon and Ceramic faces with 302 Stainless Steel spring  
b. PPS Polymer (Ryton®) spring/seal retainer

**Shafts** — 630 Stainless Steel

**Hose**

**Connectors** — PPS Polymer (Ryton®)

**Gears** — PPS Polymer (Ryton®)

**O-Rings**

**(Elastomers)** — Viton®/Fluoroelastomer

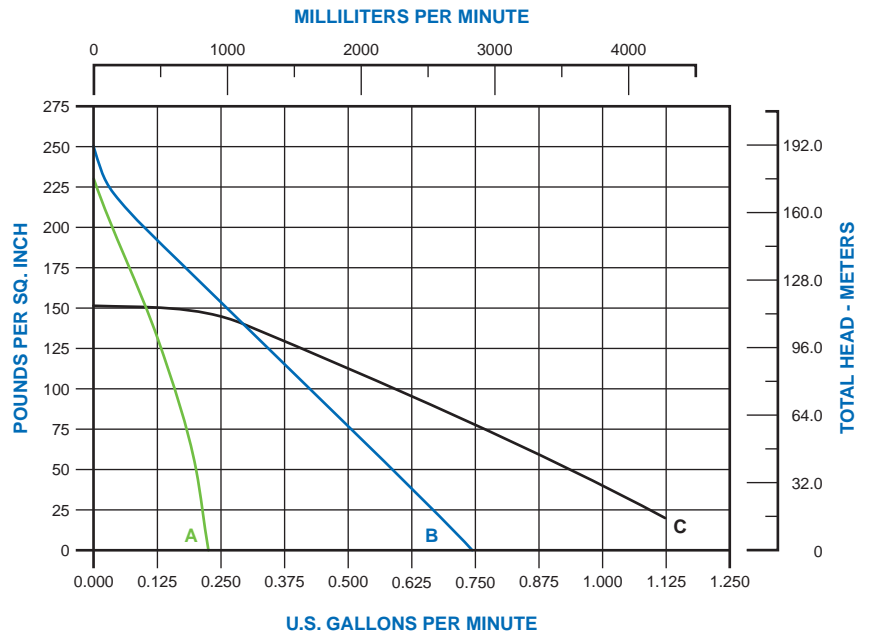

A - 12VDC curve (.080" gears).  
B - 12VDC curve (.264" gears).  
C - 12VDC curve (.537" gears).

## MODEL SPECIFICATIONS

Model Number	Series	Volts	Motor Type	Gear Thickness	Typical Curve	Approx. Wt.
					12VDC	
19002-001	2000	12VDC	Brush	.080"	A	3.5 lbs.
19002-002	2000	12VDC	Brush	.264"	B	3.5 lbs.
19002-003	2000	12VDC	Brush	.537"	C	3.5 lbs.

Note: Motor amps affected by flow rate. Consult factory for specs.

## GEAR PUMPS - TYPICAL DIMENSIONS

### 2000 Series Model

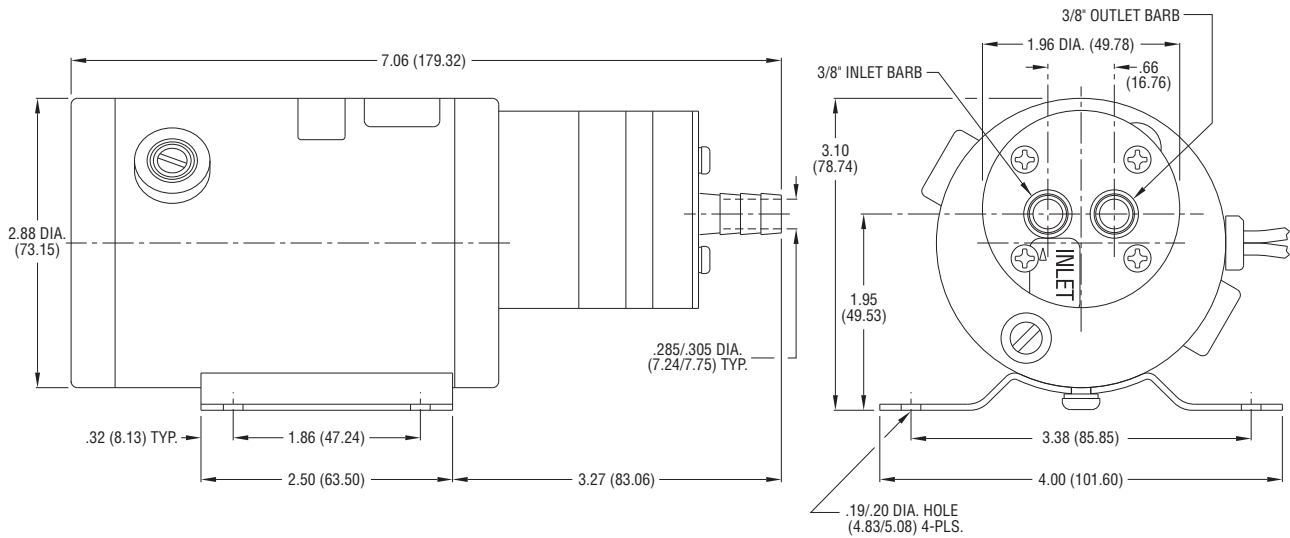

Dimensions in Inches  
(Dimensions in Millimeters)

## OEM Options

**O-Rings  
(Elastomers)** — a. EPT/EPDM  
b. Nitrile  
c. Aflas®

**Hose  
Connectors** — PPS Polymer (Ryton®)  
a. 1/8" hose barb  
b. 1/4" hose barb  
c. 3/8" hose barb

**Gears** — PPS Polymer (Ryton®) —  
3 different gear sizes  
available